



GARCÍA LORCA, FEDERICO. *Mariana Pineda*, 1927. In: **García Lorca, Federico and Hernández, Mario. *Dibujos***. (Barcelona, 1986) 860"19"GAR.09 Her. From: **CRAI Library at University of Barcelona - Philology CRAI Library**.



GARCÍA LORCA, FEDERICO. *Marinero del «Moreno»*, 1934. In: **García Lorca, Federico and Hernández, Mario.** *Dibujos.* (Barcelona, 1986) 860"19"GAR.09 Her. From: **CRAI Library at University of Barcelona - Philology CRAI Library.**



GARCÍA LORCA, FEDERICO. *Antoñito el Camborio*, 1928. In: **García Lorca, Federico and Hernández, Mario.** *Dibujos*. (Barcelona, 1986) 860"19"GAR.09 Her. From: **CRAI Library at University of Barcelona - Philology CRAI Library.**



A Rosa Montanyà  
Federico García Lorca.

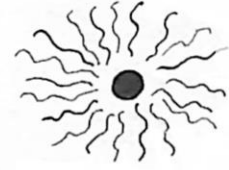

Dama en el balcón  
Federico García Lorca  
1927

GARCÍA LORCA, FEDERICO. *Dama en el balcón*, 1927. In: **García Lorca, Federico** and **Hernández, Mario**. *Dibujos*. (Barcelona, 1986) 860"19"GAR.09 Her. From: **CRAI Library at University of Barcelona - Philology CRAI Library**.

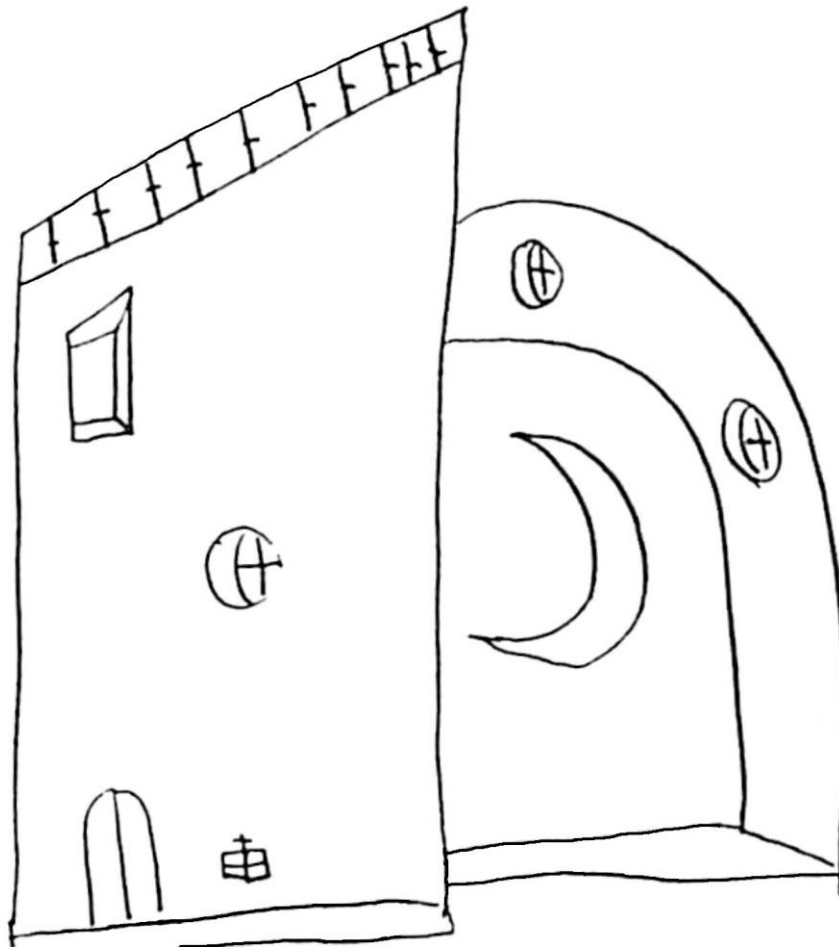

GARCÍA LORCA, FEDERICO. *Casa con arco y luna*, 1933-1936. In: **García Lorca, Federico** and **Hernández, Mario**. *Dibujos*. (Barcelona, 1986) 860"19"GAR.09 Her. From: **CRAI Library at University of Barcelona - Philology CRAI Library**.

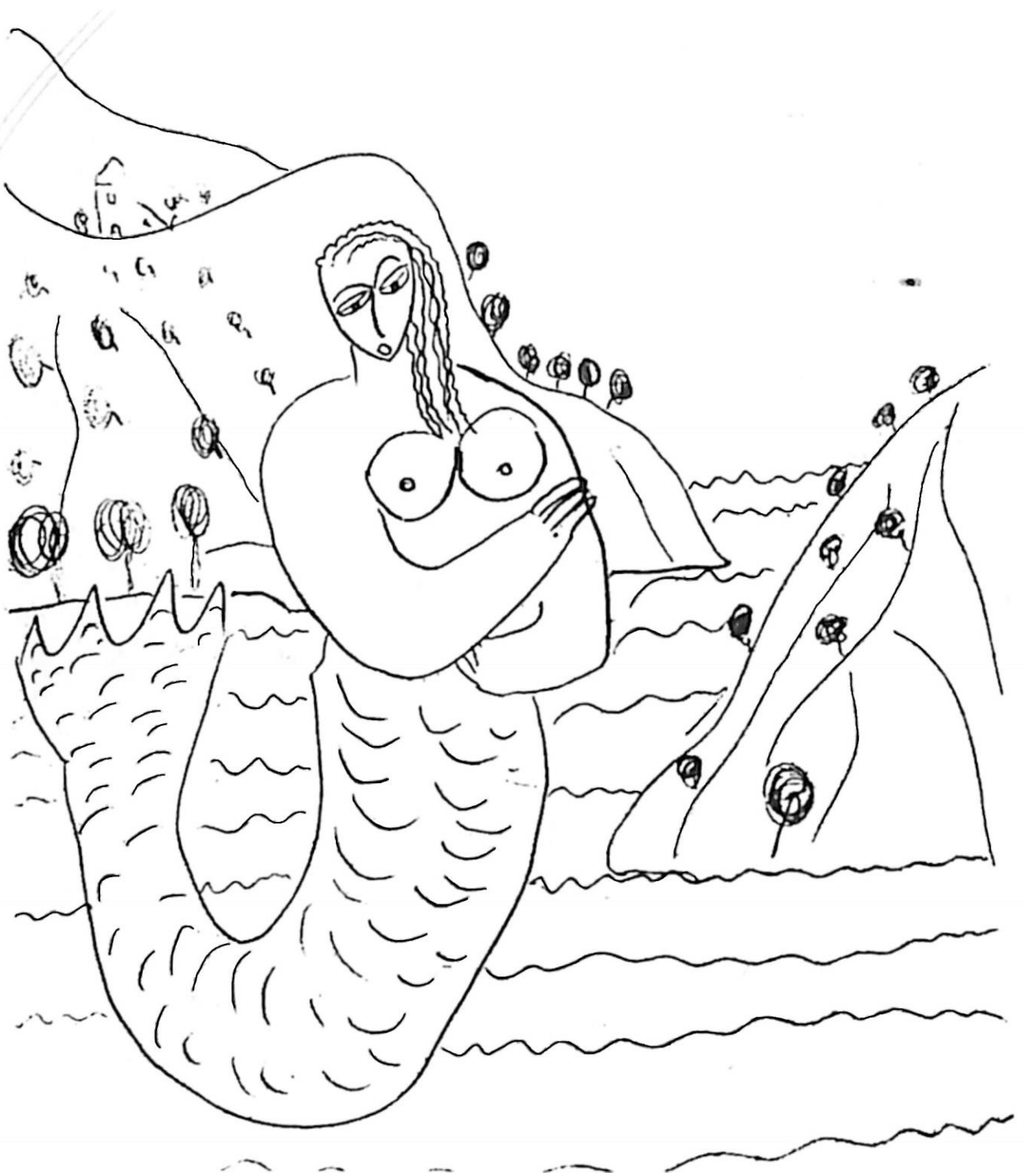

GARCÍA LORCA, FEDERICO. *Sirena*, h. 1924. In: **García Lorca, Federico and Hernández, Mario. *Dibujos***. (Barcelona, 1986) 860"19"GAR.09 Her. From: **CRAI Library at University of Barcelona - Philology CRAI Library**.



GARCÍA LORCA, FEDERICO. *El marinero borracho*, 1934. In: **García Lorca, Federico and Hernández, Mario.** *Dibujos*. (Barcelona, 1986) 860"19"GAR.09 Her. From: **CRAI Library at University of Barcelona - Philology CRAI Library.**





GARCÍA LORCA, FEDERICO. *Retrato de Salvador Dalí*, 1927. In: **García Lorca, Federico and Hernández, Mario.** *Dibujos*. (Barcelona, 1986) 860"19"GAR.09 Her. From: **CRAI Library at University of Barcelona - Philology CRAI Library.**





GARCÍA LORCA, FEDERICO. *Ilustración del 900*, 1930. In: **García Lorca, Federico and Hernández, Mario.** *Dibujos.* (Barcelona, 1986) 860"19"GAR.09 Her. From: **CRAI Library at University of Barcelona - Philology CRAI Library.**



GARCÍA LORCA, FEDERICO. *Mariana Pineda*, 1927. In: **García Lorca, Federico and Hernández, Mario. Dibujos.** (Barcelona, 1986) 860"19"GAR.09 Her. From: **CRAI Library at University of Barcelona - Philology CRAI Library.**



GARCÍA LORCA, FEDERICO. *Estampa segunda: sala principal en la casa de Mariana. Esbozo, 1927.* In: **García Lorca, Federico** and **Hernández, Mario**. *Dibujos*. (Barcelona, 1986) 860"19"GAR.09 Her. From: **CRAI Library at University of Barcelona - Philology CRAI Library**.